

4Matic offers Hand Lever Operated Investment Casting WCB / CF8 / CF8M Wafer Ball Valve Two Piece Design.



Size Range : 1" to 4" Wafer Type

Item	Type of Test	Testing Pressure	Working Pressure	Operating Temperature (High Temp. On Request)
Valve Body Flanged 150#	Hydraulic	450 PSIG	315 PSIG	Max.180 °C

Standard

Design And Manufacturing : ASME B 16.34 / API 6D
 Valve Face To Face Dimension : As Per Manufacturer
 Flange Standard Conformity : ASME B 16.5 Class 150
 Inspection & Testing : API 598 / FCI - 70-2 / BS EN 12266 - 1

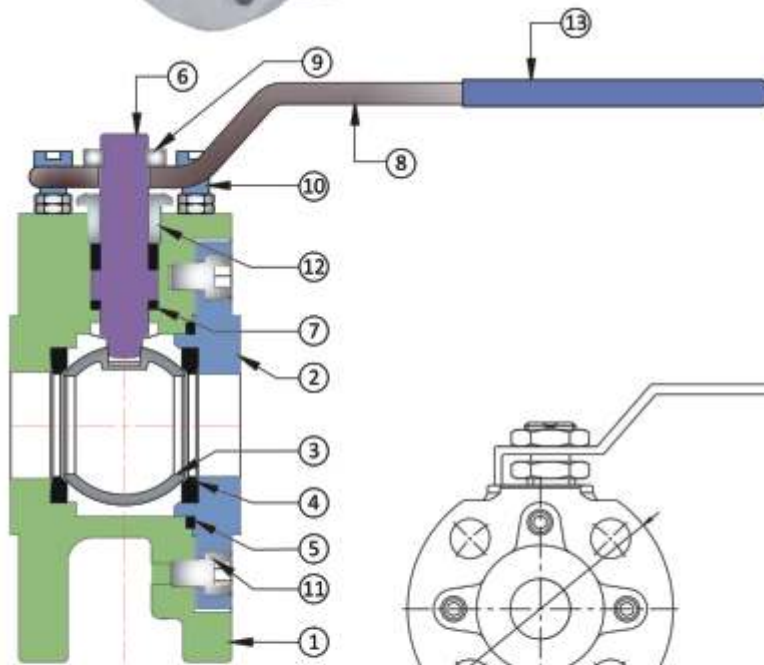

No.	Description	Material	Qty.
1	Body	WCB / CF8 / CF8M	1
2	Connector	WCB / CF8 / CF8M	1
3	Ball	CF8 / CF8M	1
4	Ball seat	PTFE / GFT / CFT / PEEK	2
5	Body Seat	PTFE / GFT / CFT / PEEK	1
6	Stem pin	AISI 304 / 316	1
7	Stem Seat	PTFE	4
8	Handle	M.S. / S.S.	1
9	Handle Nut	ASTM A 193	1
10	Handle Stopper	S.S.	2
11	Allen Bolt	ASTM A 193	4
12	Lock Nut	CF8	1
13	Handle Sleeve	PVC Grip	1

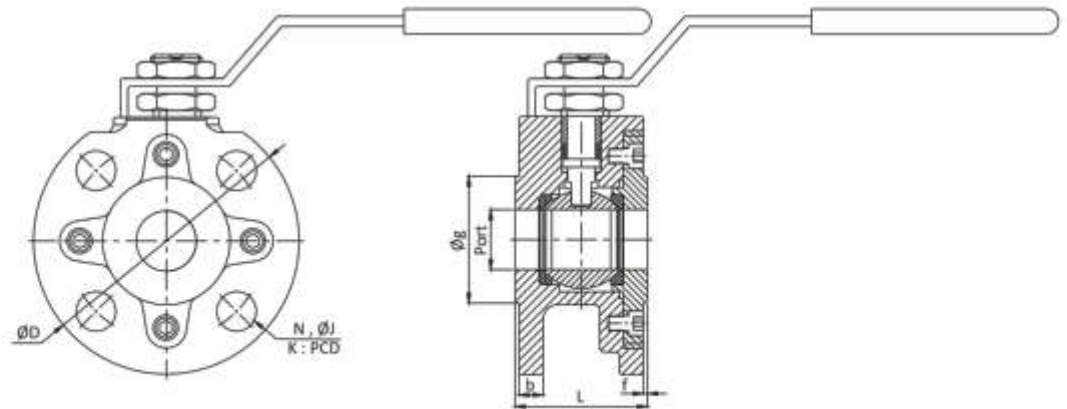

Dimensions :

(All Dimensions are in mm)

Valve Model	Valve Size		L	b	f	Port	øg	øD	øJ	N	PCD	Weight
	MM	Inch										
4WFB - 25	25	1"	54	9.6	2	25	50.8	107.9	15.88	4	79.4	1.940
4WFB - 32	32	1.1/4"	58.5	11.2	2	32	63.50	115	15.88	4	88.9	2.900
4WFB - 40	40	1.1/2"	63	12.7	2	38	73	127	15.88	4	98.4	3.080
4WFB - 50	50	2"	73	14.3	2	49	91.95	152.4	19.05	4	120.7	4.900
4WFB - 65	65	2.1/2"	96	15.9	2	62	104.65	177.8	19.05	4	139.7	8.560
4WFB - 80	80	3"	118	17.5	2	74	127	190.5	19.05	4	152.4	11.140
4WFB - 100	100	4"	140	22.3	2	100	157.2	230	19.05	8	190.5	18.240

4Matic offers Hand Lever Operated Investment Casting WCB / CF8 / CF8M / Ball Valve in 2 Piece Design Wafer Type JACKETED- engineered for multiple ON / OFF operations in the down steam

Size Range : 1" to 4"

Standard

Design And Manufacturing : ASME B 16.34 / API 6D
 Valve Face To Face Dimension : As Per Manufacturer
 Flange Standard Conformity : ASME B 16.5 Class 150, 300
 Inspection & Testing : API 6D / FCI - 70-2 / BS EN 12266 - 2

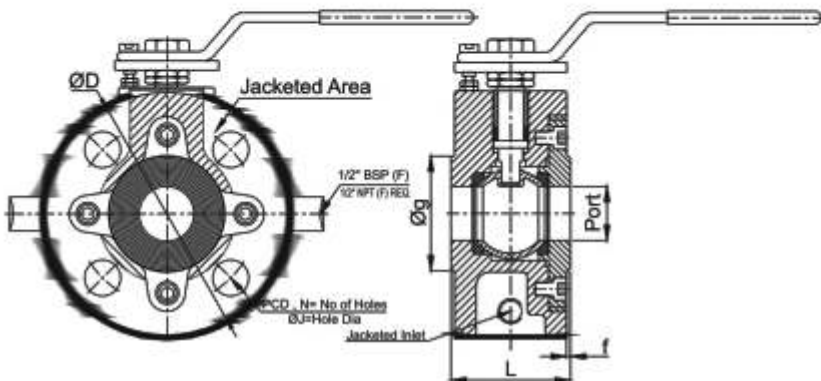
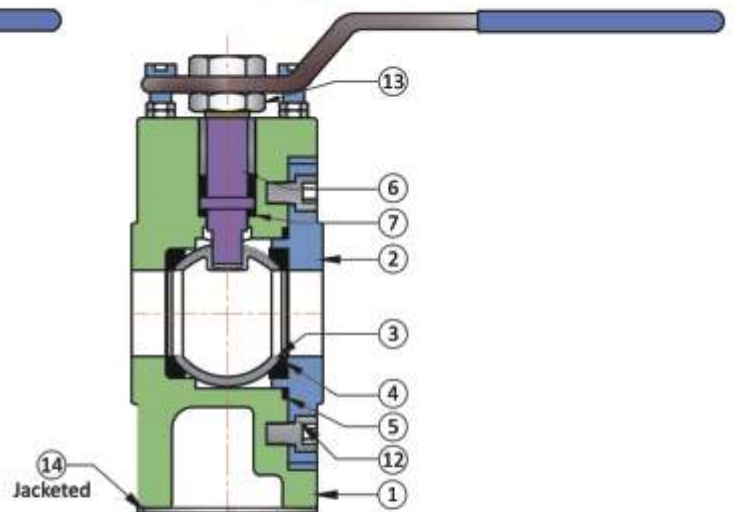
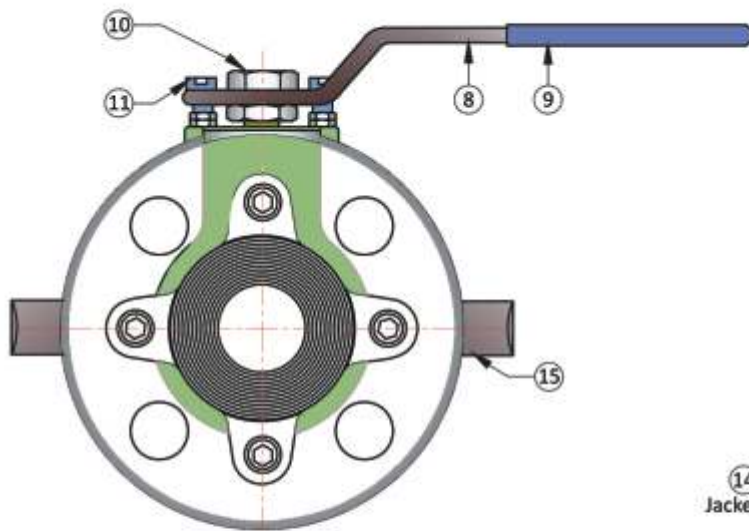

No.	Description	Material	Qty.
1	Body	WCB / CF8 / CF8M	1
2	Connector	WCB / CF8 / CF8M	1
3	Ball	CF8 / CF8M	1
4	Ball seat	PTFE / GFT / CFT / PEEK	2
5	Body Seat	PTFE / GFT / CFT / PEEK	1
6	Stem Pin	AISI 304 / 316	1
7	Stem Seat	PTFE	4
8	Handle	M.S. / S.S.	1
9	Handle Sleeve	PVC Grip	1
10	Handle Nut	S.S.	1
11	Handle Stopper	S.S.	2
12	Allen Bolt	S.S.	4
13	Lock Nut	S.S.	1
14	Jacket	S.S. / M.S.	1
15	Coupling	S.S. / M.S.	2

Dimensions :

(All Dimensions are in mm)

Valve Model	Valve Size		Port	L	ØD	ØE	ØJ	N	f	PCD	Weight (Approx.)
	MM	Inch									
4WFX - 25	25	1"	25	54	107.9	50.8	15.88	4	2	79.4	2.500
4WFX - 32	32	1.1/4"	32	58.5	115	63.50	15.88	4	2	88.9	3.300
4WFX - 40	40	1.1/2"	38	63	127	73	15.88	4	2	98.4	3.960
4WFX - 50	50	2"	49	73	152.4	92.1	19.05	4	2	120.7	5.940
4WFX - 65	65	2.1/2"	62	96	177.8	104.8	19.05	4	2	139.7	10.800
4WFX - 80	80	3"	74	118	190.5	127	19.05	4	2	152.4	13.620
4WFX - 100	100	4"	100	140	230	157.2	19.05	8	2	190.5	22.900